

Varenummer: 58SE100S0800G

Beskrivelse: Cylinder ISO15552 SE 100x800-S-G Ø100-800  
port 1/2 - med luftdæmpning

## Mål

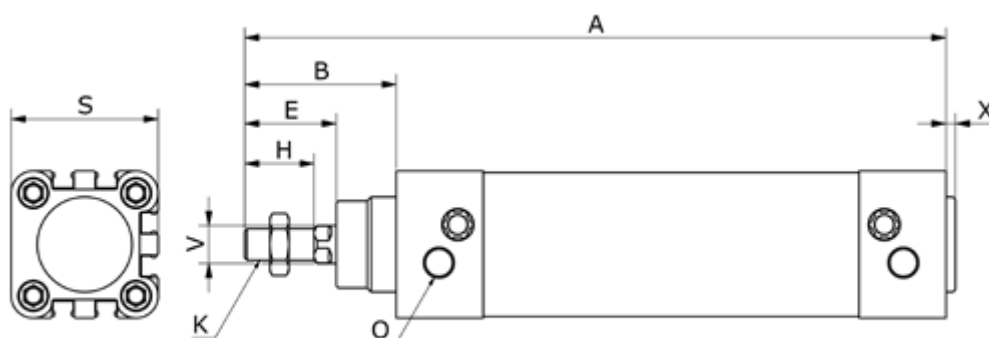

|                 |            |                  |
|-----------------|------------|------------------|
| A               | = 1029     | Slaglængde = 800 |
| B               | = 91       | V = 25           |
| Boringsdiameter | = 100      | X = 4            |
| E               | = 55       |                  |
| HS              | = 40       |                  |
| K               | = M20x1,50 |                  |
| O               | = 1/2"     |                  |
| S               | = 110.0    |                  |